

GARAGE DOORS



WIŚNIEWSKI

GATES | WINDOWS | DOORS | FENCES

SECTIONAL DOORS **UniPro SNP**

Intended use: The sectional garage doors are dedicated primarily for buildings with a low lintel, with little space for torsion springs and narrow side clearance, making it impossible to use traditional solutions. The weight of the door is balanced by a properly selected pull spring system installed along the vertical tracks.

THERMAL INSULATION

Steel panels are made of galvanized sheet, filled with freon-free, hardened polyurethane foam and coated with polyester paint on both sides. This ensures very good thermal insulation and acoustic properties. Each door features a system of flexible and robust gaskets both along the entire circumference and between the panels, which considerably contributes to the insulating qualities of the door.

SAFETY

Safety systems focus on minimizing all traces of risk. Regardless of the method of operation, WIŚNIEWSKI doors ensure comfort, safety, and security. Our products are fully compliant with the PN-EN 13241-1 standard.

FUNCTIONALITY

With a pull spring system installed along vertical tracks, the doors can be installed in buildings with low lintels. The SNP door design enables easy and quick operation.



UNIPRO SNP DOOR DESIGN

The sectional door is installed behind the opening, it opens vertically upwards, and does not take up any space in the driveway. The space in front of the door, as well as inside the building, is used to its full potential, and the door tracks allow the door to operate without colliding with anything inside the garage. Numerous protective devices ensure safe opening and closing, regardless of the method of operation: manual or automatic.

Thanks to the pull spring system installed along the vertical tracks, the door can be fitted in buildings with low lintels. The number of springs is adapted to the door size, which provides maximum comfort and safety of use. The shape of the panels is designed to prevent fingers from being crushed. All the steel elements are galvanized (tracks, frames, fastening elements). The door is fitted with rollers with bearings which ensure proper guiding of the door leaf, while a dedicated profile of the tracks prevents derailing.

Large dimension gates are additionally reinforced with special elements that increase the rigidity of the entire structure, such as an additional hinge fitted in the middle of the door or a door leaf reinforcing profile. Door panels are coated with high quality polyester paints or film-coated. This provides optimum protection against the weather conditions and ensures many years of operation. Thanks to the vast range of colours, WIŚNIEWSKI garage doors can be easily matched to the building's façade. WIŚNIEWSKI doors are an investment that stands the test of time.



- 1 Automatic operating units**
Proven and reliable automatic operating units: METRO Smart io, MOTO io or SPARK.
- 2 Tracks and opening frames**
Made of galvanized sheet, they provide a stable and durable structure.
- 3 Panel hardware in the RAL 9002 colour**
The colour matches the panel colour on the inside.
- 4 Bottom gasket**
High quality EPDM gaskets perfectly adapt to the shape of the floor and prevent water and dirt from penetrating under the door to the inside of the garage.



Pull springs
A pull spring system mounted along the vertical tracks. Guaranteed minimum number of cycles - 20,000.



Overload safety device
In automatic doors, the door leaf stops and reverses when the bottom edge contacts an obstacle.



Double-lip circumferential seal
Used as standard, they ensure improved sealing of the door.

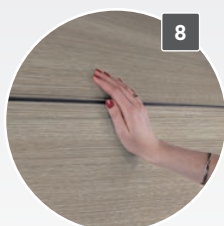

Special panel shape
They prevent fingers from being crushed.



Guiding rollers with bearings
They ensure proper running of the door leaf.



Photocells
They prevent uncontrolled door leaf operation when an obstacle is present within the clear passage - optional accessory.



U THERMAL TRANSMITTANCE FACTOR [W/m²K]

		Door width in [m]														
		2,250	2,375	2,400	2,500	2,600	2,750	3,000	3,250	3,500	3,750	4,000	4,250	4,500	4,750	5,000
Door height in [m]	2,000	1,3	1,3	1,3	1,3	1,3	1,3	1,3	1,3	1,3	1,3	1,3	1,3	1,3	1,3	1,3
	2,100	1,3	1,3	1,3	1,3	1,3	1,3	1,3	1,3	1,3	1,3	1,3	1,2	1,2	1,2	
	2,125	1,3	1,3	1,3	1,3	1,3	1,3	1,3	1,3	1,3	1,3	1,2	1,2	1,2	1,2	
	2,200	1,3	1,3	1,3	1,3	1,3	1,3	1,3	1,2	1,2	1,2	1,2	1,2	1,2		
	2,250	1,3	1,3	1,3	1,3	1,3	1,3	1,2	1,2	1,2	1,2	1,2	1,2	1,2		
	2,375	1,3	1,3	1,3	1,3	1,3	1,3	1,2	1,2	1,2	1,2	1,2	1,2			
	2,500	1,3	1,3	1,3	1,3	1,3	1,3	1,2	1,2	1,2	1,2	1,2	1,2			
	2,625	1,3	1,3	1,3	1,3	1,3	1,3	1,3	1,3	1,2	1,2	1,2				
	2,750	1,3	1,3	1,3	1,3	1,3	1,3	1,2	1,2	1,2	1,2					
	2,875	1,3	1,3	1,3	1,3	1,3	1,3	1,2	1,2	1,2						
	3,000	1,3	1,3	1,3	1,3	1,3	1,3	1,2	1,2	1,2						

The factors are provided for doors SNP without glazing, ventilation grilles, aluminium panels or additional thermal gaskets.

INSTALLATION DIMENSIONS

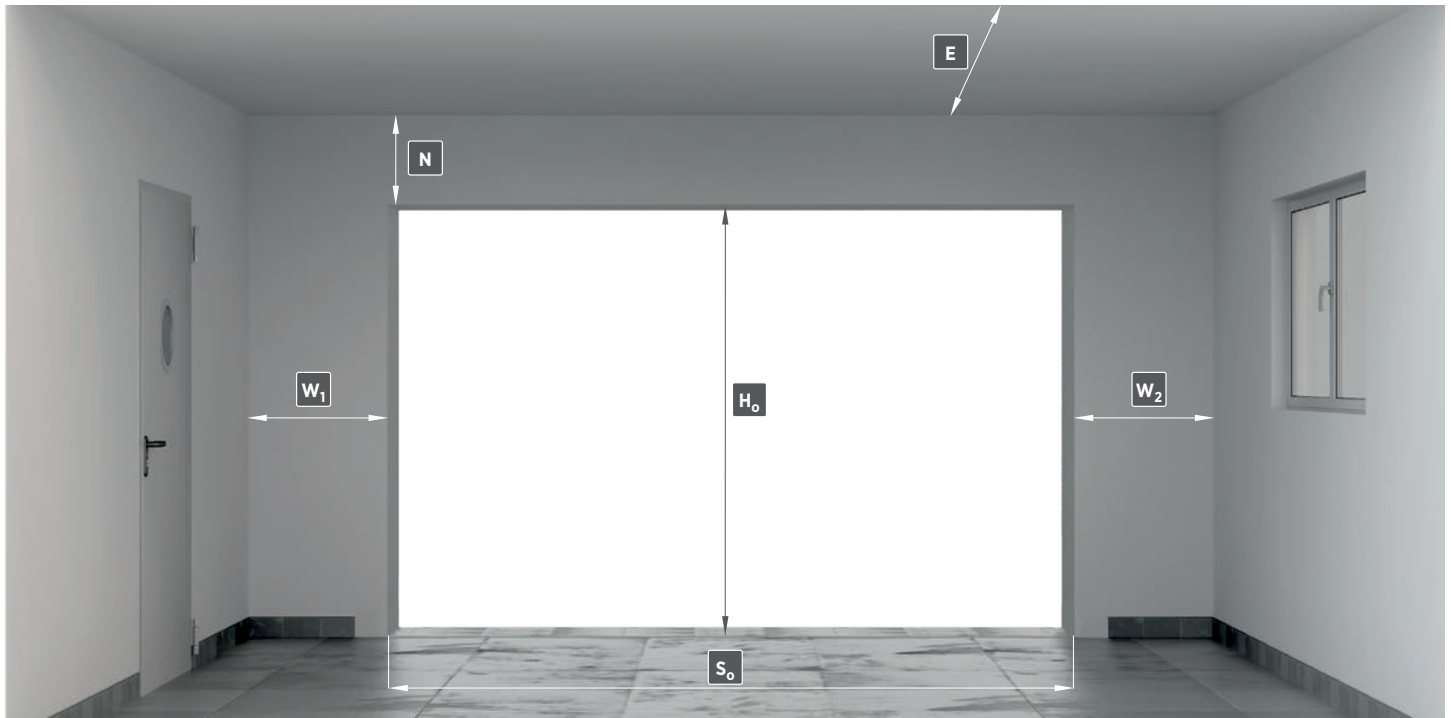

S_o - opening width, ordering dimension

H_o - opening height, ordering dimension

N - minimum required lintel height

W₁ - minimum required side clearance

W₂ - minimum required side clearance

E - minimum garage depth with clearance under the ceiling



PANEL STRUCTURE

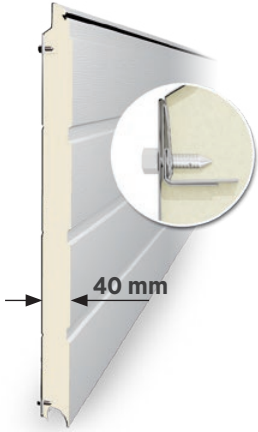

Robust and reliable design

We consistently follow the same design principles for our whole range of sectional garage doors. Thanks to our robust and reliable design, you can rest assured that the door will meet even the most extreme requirements and withstand the most demanding operating conditions. Special solutions, such as our proprietary panel built using the **5-ply** sheet bending system, ensure stable fixation of elements, which further contributes to the strength of the structure. The top section is fitted with a lip gasket. The internal side of the panel in the RAL 9002 colour. The panel is infilled with polyurethane foam whose composition is precisely determined by our specialists.

RIB TYPES



G - without ribs



W - high ribs



N - low ribs



K - caisson ribs



V - V ribs

TEXTURES



Woodgrain



Smoothgrain

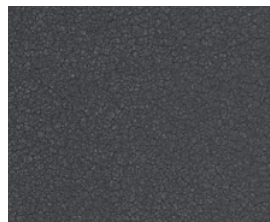

Sandgrain

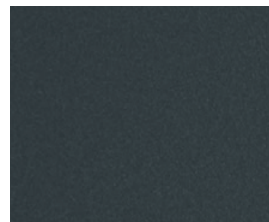

Silkline



Silkline, panel with V ribs



TRACK SPECIFICATION

SNP tracks

Pull springs mounted along the vertical tracks.



Minimum garage door dimensions:

- $S_o = 1500$ [mm] and $H_o = 1800$ [mm] – garage doors type **N**
- $S_o = 1500$ [mm] and $H_o = 1900$ [mm] – garage doors type **G**, **W**, **V**
- $S_o = 2230$ [mm] and $H_o = 1990$ [mm] – garage doors type **K**
- $S_o \leq 1750$ [mm] and $H_{o\ max} = 2500$ [mm], 1750 [mm] < S_o < 2000 [mm] $H_{o\ max} = 2750$ [mm].

Available range of dimensions for tracks

Opening height ⁽¹⁾ (H_o) in [mm] up to	Opening width ⁽¹⁾ (S_o) in [mm] up to														
	2250	2375	2400	2500	2600	2750	3000	3250	3500	3750	4000	4250	4500	4750	5000
2000															
2100															
2125															
2200															
2250															
2375															
2500															
2625															
2750															
2875															
3000															

⁽¹⁾ - Ordering dimension.

– not applicable for doors with Sandgrain and RAL 9005 Silkline.

Installation dimensions

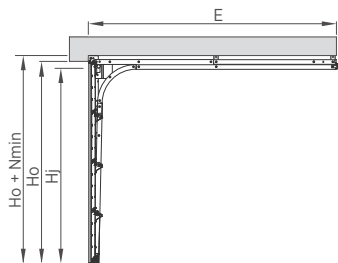

<input checked="" type="checkbox"/> <input checked="" type="checkbox"/> S NP <input type="checkbox"/>		SNPN, SNPG, SNPW, SNPK		SNPV
Colour/Structure		all available colour and structure combinations		RAL 9006, RAL 7016, other RAL (silklime)
Dimension		standard	special	special
Nmin	Manual	90 [mm]		
	With the MOTO drive	100 [mm]		
	With the METRO drive	120 [mm]		
	With the SPARK drive	120 [mm]		
Sj		$S_o - 40$ [mm]		
Hj	Manual + catcher (standard)	$H_o - 60$ [mm]		
	With a drive unit	$H_o - 60$ [mm]		
W1, W2		100 [mm]		
Emin	Manual	$H_o + 600$ [mm]		
	With the MOTO drive	$L_S + 300$ [mm]		
	With the METRO drive	$L_S + 410$ [mm]		
	With the SPARK drive	$L_S + 363$ [mm]		
Ls	With the MOTO drive	2900 [mm] for $H_o \leq 2250$; 3500 [mm] for $H_o > 2250$ and $H_o \leq 2850$; 4500 [mm] for $H_o > 2850$		
	With the METRO drive	2900 [mm] for $H_o \leq 2250$; 3500 [mm] for $H_o > 2250$ and $H_o \leq 2850$; 4500 [mm] for $H_o > 2850$		
	With the SPARK drive	3288 [mm] for $H_o \leq 2250$; 3831 [mm] for $H_o > 2250$ and $H_o \leq 2750$; 4384 [mm] for $H_o > 2751$ [mm]		

So – opening width, ordering dimension. **Sj** – clear passage width after garage door installation. **Ho** – opening height, ordering dimension. **Hj** – clear passage width after garage door installation. **N** – minimum required lintel height. **W1** – minimum required side clearance. **W2** – minimum required side clearance. **E** – minimum garage depth with clearance under the ceiling. **Ls** – drive rail length.



AVAILABLE COLOURS:

 Anthracite sandgrain	 Golden Oak woodgrain	 Walnut woodgrain	 Graphite RAL 7016 woodgrain	 Graphite RAL 7016 silkline	 Black RAL 9005 silkline
 Brown RAL 8014 woodgrain	 Silver RAL 9006 woodgrain	 Silver RAL 9006 silkline	 White RAL 9016 woodgrain	 White RAL 9016 silkline	 Golden Oak smoothgrain
 Walnut smoothgrain	 Anthracite Grey 701605-167 smoothgrain	 Cream white 137905-167 smoothgrain	 Dark Green 612505-167 smoothgrain	 Metbrush silver F436-1002 smoothgrain	 Silbergrau 116700 smoothgrain
 White 915205-168 smoothgrain	 Chocolate Brown 887505-1167 smoothgrain	 Anthracite Quartz 436-1014 smoothgrain	 AnTEAK 3241002-195 smoothgrain	 Dark Oak 2052089-167 smoothgrain	 Swamp Oak 3167004-167 smoothgrain
 Summer Cherry 3214009-195 smoothgrain	 Macore 3162002-167 smoothgrain	 Oregon 1192001-167 smoothgrain	 Sapelli 2065021-167 smoothgrain	 Siena noce 49237 PN smoothgrain	 Siena PL 49254-015 smoothgrain
 Siena rosso 49233 PR smoothgrain	 Winchester 49240 XA smoothgrain	 Black Cherry 3202001-167 smoothgrain	 Natural Oak 3118076-1168 smoothgrain	 Douglas Fir 3152009-1167 smoothgrain	 Rustic Oak 3149008-167 smoothgrain
 Sheffield oak brown F 436-3087 smoothgrain	 Sheffield oak light F 456-3081 smoothgrain	 Sheffield oak grey F 436-3086 smoothgrain	 Brush schwarzbraun F436-1023 smoothgrain	 Earl platin 119500 smoothgrain	 Black ulti-mat PX47097 smoothgrain
 Woodec Turner Oak Malt F4703001 smoothgrain	 Woodec Sheffield Oak Alpine F4703002 smoothgrain	 Woodec Sheffield Oak Concrete F4703003 smoothgrain	 Umbragrau F436-6065 smoothgrain	 Fenstergrau F436-6066 smoothgrain	 Cremeweiss F456-6001 smoothgrain
 Anthrazitgrau F436-6003 smoothgrain	 Dark grey silk 4367003 smoothgrain	 Golden Oak 2178001-167 smoothgrain	 Walnut 2178007-167 smoothgrain	 Anthracite Quartz Matt F4701014 smoothgrain	 Woodec Turner Oak Toffee F4703004 smoothgrain
 Irish Oak 3211305-1148 smoothgrain	 Sable Noir 2100 silkline	 Sable Noir 2100 woodgrain	 <p>Our paint range includes over 200 colours from the RAL palette.</p>  <p>Film coatings available with garage doors with the panel: G - without ribs or W - with high ribs</p>		



HOME INCLUSIVE 2.0 colours

The Home Inclusive 2.0 colour collection combines four product groups: Gates | Windows | Doors | Fences, which provide a consistent design of all the products.

HI EARTH

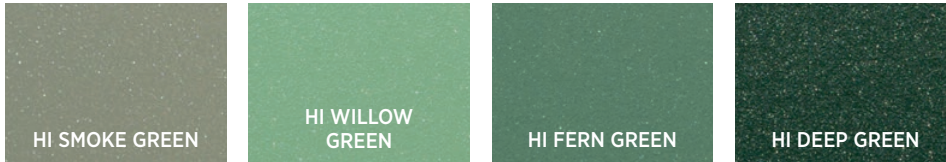

HI STONE



HI STEEL



HI RUBY

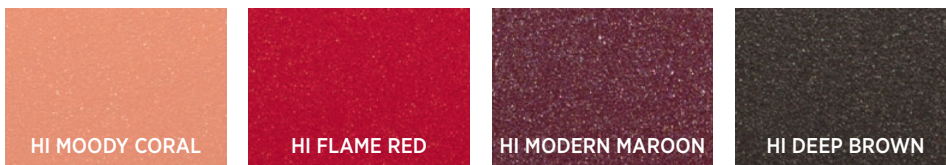

Doors in light colours should be fitted on the side exposed to sunlight. It is not recommended to fit dark colour doors in such conditions, in particular RAL: 3007, 4006, 4007, 5004, 5008, 5010, 5011, 5020, 5022, 6008, 6009, 6015, 6022, 7015, 7016, 7021, 7024, 7026, 7043, 8014, 8019, 8022, 9004, 9005, 9011, 9017, 9021, Anthracite, Walnut, Macore, Dark Oak, Swamp Oak, Siena Noce, Siena Rosso, Quartz Anthracite, Summer Cherry, Sapeli, Dark Green, Sheffield Oak Brown, Rustic Oak, Chocolate Brown, Black Ulti-Mat, Brush Schwarzbraun, Umbragrau, Anthrazitgrau.

When a dark colour is chosen for doors installed on the side exposed to sunlight, the panels can heat up excessively, which may result in deformation. The door leaf cannot be painted from the inside. When ordering doors in matching colours in different orders (delivery batches), the colour hues can differ due to technological reasons.

OPTIONAL ACCESSORIES

PORTHOLES

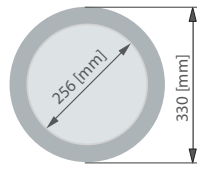
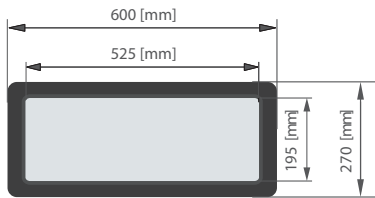

Type O-1A

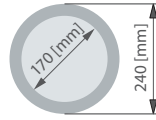

Type O-2A

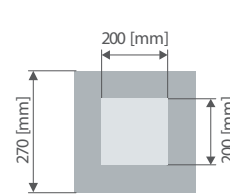

Type R-1A

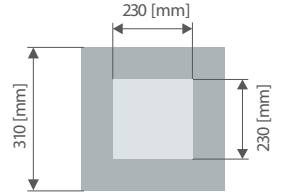

Type R-2A

Type A-1 – made of double, clear acrylic glass, with a rough frame surface. The external frame is available in RAL 7016, RAL 8003, RAL 8011, RAL 8014, RAL 8017, RAL 9005, RAL 9016. The internal frame is always white. Internal/external frame made of PVC. External dimensions of the frame: 600 x 270 [mm]. Light transmission 86%.

Type O-1A, O-2A – infill: triple, clear, acrylic glazing unit; frame (ext./int.): stainless steel, satin. Not available with doors with caisson ribs. Available with doors up to So=3,750 mm.

Type R-1A, R-2A – infill: triple, clear, acrylic glazing unit; frame: stainless steel, satin. Not available with doors with caisson ribs. Available with doors up to So=3,750 mm.

GLASS

Intended use: for double glazing of glazed aluminium panels and VISUAL glazing.



No-Scratch

Glass pane with a special coating improving its strength, very good resistance to scratching and sunlight compared to standard glass.



Satin

Opaque glass pane. Double glazed pane opaque from the outside and clear from the inside. Light transmission 78%.



Glass pane SAN R

Opaque (so-called frosted) double glazed pane clear from the inside. Light transmission (77-79%).



Grey

Clear glass with a slight brown hue. Double glazed pane, clear from the inside, non-coloured from the inside. Light transmission (51%).

VENTILATED PANEL



Aluminium panel without a thermal break or with a thermal break, infilled with expanded mesh. The door can be fitted with only one ventilated panel.

RC2 ANTI-BURGLARY KIT



The garage door fitted with the RC2 kit has a certificate issued by the IFT Rosenheim (Germany) notified body. The kit includes: automatic locking mechanism, reinforced deadbolt system, deadbolt plates, safeguard preventing the carriage from being unlocked, and a track bumper.

The RC2 kit is only available for doors with the MOTO and METRO drive units.



LOCK/HANDLE

The lock is fitted with a single-side lock cylinder, the lock cylinder is accessible from the outside (three keys), from the inside the lock is operated with a latch. In the manually operated SNP door with $S_o \geq 4,000$ [mm], the lock engages the deadbolt on both sides (single-side locking is available as an optional accessory). On the outside of the door leaf, a plastic handle with a cover plate type PVC-1 or KL-2 is fitted. A black plastic handle is installed on the inside. The UniPro SNP and SNP 2.0 doors are not available with a handle fitted in the middle of the door. The PVC-1 handle is available in black. The KL-2 handle is available in the following colours:

- **MAT** – RAL 9005, RAL 9016, RAL 8014.
- **GLOSS** – RAL 9006, RAL 1036, RAL 1035, RAL 7048.



KL-2 handle, colour: RAL 9006



KL-2 handle, colour: RAL 1036



KL-2 handle, colour: RAL 1035



KL-2 handle, colour: RAL 7048



KL-2 handle, colour: RAL 9016



KL-2 handle, colour: RAL 9005



KL-2 handle, colour: RAL 8014



Standard handle

ADDITIONAL SEALS

The UniPro SNP doors are fitted with circumferential double-lip seals as standard. The UniPro SNP door can be fitted with additional **thermal seals**, which enable the structural steel elements to be isolated from the wall surface, or **finishing thermal seals**, which make it possible to provide an aesthetic finish of the garage door opening by eliminating the gap between the thermal insulation and the door leaf surface, which further improves door insulation.

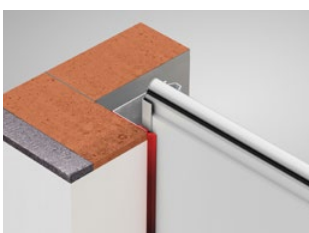

Thermal seal

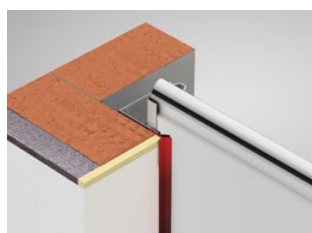

Finishing thermal seal



EXAMPLE UNIPRO SNP DOOR MODELS

GLAZING



Garage door with portholes - type A-1



Garage door with portholes - type C-1



Garage door with portholes - type E-1



Garage door with portholes - type O



Garage door with portholes - type O-1A,
stainless steel frame



Garage door with portholes - type O-2A,
stainless steel frame



Garage door with portholes - type R-1A,
stainless steel frame



Garage door with portholes - type R-2A,
stainless steel frame



Garage door with portholes - type W3-1



Garage door with portholes - type W4-1



Garage door with portholes - type W5-1



Garage door with portholes - type W6-1



DECORATIVE MOTIFS



Type Ap-1



Type Ap-2



Type Ap-3



Type Ap-4



Type Ap-5



Type Ap-6

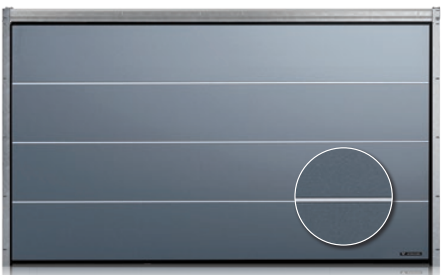

Type Ap-7 in garage doors with panels without ribs



Type Ap-7 in garage doors with panels with high ribs



The Ap-1 – Ap-6 decorative motifs are available in stainless steel colour and RAL 9005. Ap7 decorative motifs are available in stainless steel and copper-clad stainless steel colours.

OTHER MANUFACTURING OPTIONS



Garage door with an aluminium panel glazing



Garage door with the VISUAL glazing – available for garage door widths up to So=3,000 [mm]

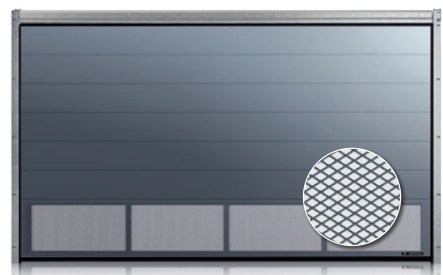

Garage door with a ventilated panel – expanded mesh



AUTOMATIC OPERATING UNIT KITS

The METRO Smart io, MOTO io, and SPARK series drive units are dedicated for garage doors and ensure full functionality and overload protection as standard.

The EXTENDED CARE warranty lets you extend the standard warranty for the complete product - automatic sectional garage door:

- up to 5 years when factory configured with the METRO Smart io or SPARK drive unit,
- up to 3 years when factory configured with the MOTO io drive unit.



Drive unit type		METRO smart io	MOTO io	SPARK
				
Technical data	Power supply / Motor	220-230V, 50/60Hz / 24V DC	220-230V, 50/60Hz / 24V DC	220-240V, 50/60Hz / 24V DC
	Force	800N / 1000N	600N / 750N	500N / 600N / 800N / 1100N
	Power consumption (power-saving mode)	< 0,5 W	< 0,5 W	< 1 W
	Efficiency	30%	30%	40%
	Track	single, steel	single, steel	split, steel
	Transmission	chain or belt*	chain or belt*	carriage
	Speed	max. 14 cm/s	max. 14 cm/s	max.: 18 / 24 / 21 / 18 cm/s
	Central control unit	integrated	integrated	integrated
	Radio receiver	io-homecontrol; integrated: 868-870 MHz	io-homecontrol; integrated: 868-870 MHz	WIŚNIOWSKI; integrated: 868 MHz
	Radio receiver storage:	30 transmitters	30 transmitters	40 transmitters
	Two-way radio transmission	yes	yes	yes
	Auto selection of operating parameters	yes	yes	yes
	Limit switches	encoder + mechanical bumper	encoder + mechanical bumper	encoder + mechanical limit switch
	Emergency uncoupling	yes	yes	yes
	Application	sectional / up and over	sectional / up and over	sectional / up and over
	Operating conditions	-20°C / +60°C ; IP20	-20°C / +60°C - in a dry room	-25°C / +65°C - in a dry room
	Wicket door opening sensor	yes	yes	yes
Rotating automatic operating unit head	yes	yes	no	
Warranty	5 years	3 years	5 years	
Functionality	Obstacle detection	yes	yes	yes
	Obstacle detection adjustment	4 adjustment levels	4 adjustment levels	4 adjustment levels
	Action following obstacle detection	stop and full opening	stop and full opening	stop and partial opening
	Photocells	yes	yes	yes
	Automatic closing	60 sec. / 120 sec. or after photoc.	yes, only with TaHoma Pro	yes / max. 240 sec.
	Release in end position	yes	yes	yes
	Low energy consumption mode	yes	yes	yes
	Independent exterior lighting	yes / 230V, 500 W	no	no
	Exterior lighting control	yes	no	no
	Auxiliary warning light	yes / 24V, 15 W	yes / 24V, 15W	yes / 24V, 25W
	Delayed drive unit light switch off	yes / fixed - 60 s	yes / fixed - 30 s	yes / fixed - 30 s
	Independent lighting control in the drive unit	yes	yes	yes
	Emergency power supply	yes	yes	yes
	Display / LEDs	no / yes	no / yes	no / yes
	Partial opening of the door - slightly open	yes	yes	yes
	Information about a fault	yes, LEDs	yes, LEDs	yes, LED
	Smart home	yes, io-homecontrol technology ⁽¹⁾	yes, io-homecontrol technology ⁽¹⁾	yes ⁽²⁾

⁽¹⁾ - for full functionality, the TaHoma switch is required.

⁽²⁾ - optional, for wired Smart Home systems; CONEX and OUTPUT boards required

* Extra charge.



OPTIONAL ACCESSORIES FOR THE METRO AND MOTO AUTOMATIC OPERATING UNITS

WALL-MOUNTED TRANSMITTER



The 3-channel transmitter makes it possible to control drive units and wireless receivers. Examples of use:

- - full opening/closing the door,
- - LED lighting under the tracks, and/or under the track fastener,
- - top panel tilt.

Wireless communication makes it possible to install it in any place and doesn't require any cables.

KEYPAD 2 CODE KEYPAD



The 2-channel code keypad makes it possible to control drive units and wireless receivers.

EXTERNAL RADIO RECEIVER io



Makes it possible to control the drive units of other manufacturers using the Pulsar transmitter. It is a two-channel device which makes it possible to program as many as 32 transmitters.

BACKUP POWER SUPPLY BATTERY



When connected to the METRO Smart io and MOTO io drive, it provides power for several cycles of emergency operation.

MECHANICAL CARRIAGE LOCK



It is an additional safeguard which increases garage door safety when mounted to the carriage.

SIGNAL LIGHT



Supports the METRO Smart io and MOTO io drive units. Warning function. Orange blinking light indicates that the door is operating.

EXTERNAL CODE KEYPAD



The single-channel device can be used to control the garage door with a code. For outdoor installation, requires cabling.

PHOTOCELLS



They prevent uncontrolled door leaf movement when an obstacle is present within the clear passage.



OPTIONAL ACCESSORIES FOR THE SPARK AUTOMATIC OPERATING UNITS

2CH WALL-MOUNTED TRANSMITTER



2-channel device which lets you control both your drive units and radio receivers. Communication between the transmitter and the receiver occurs wirelessly, so the device can be mounted in any place. The wall-mounted transmitter has a feedback function that informs the user about the position of the door using a LED.

WIŚNIEWSKI 868 RADIO RECEIVER



It makes it possible to control other drive units with the DART and DART Vibe transmitters, and the wall-mounted transmitter. The radio receiver is a two-channel device operating at the frequency of 868 MHz, making it possible to program up to 40 transmitters.

LOCK - MOTOR LOCK



A magnetic lock which blocks the drive unit in any position of the door. An additional element able to withstand loads up to 300 kg, increasing door safety.

ACCU - EMERGENCY POWER SUPPLY BATTERY



Connected to the SPARK drive unit, it provides power for several cycles of emergency operation in case of the main power supply outage.

PHOTOCELLS 180



Prevent uncontrolled door leaf movement when an obstacle is present within the clear passage.

SIGNAL LIGHT



Connected to the SPARK drive unit, it has a warning function. Orange blinking light indicates that the door is operating.

CONEX - INPUT BOARD



Additional board with signal, impulse inputs, whose inputs were defined for opening and closing. Compatible with wired Smart Home systems.

OUTPUT - SIGNAL BOARD



Additional board with a signal input. Information about the position of the door: door not open (NO)/door not closed (NC). Compatible with wired Smart Home systems.

DART/ DART VIBE REMOTE CONTROL TRANSMITTER



The transmitter makes it possible to control the operation of several drive units. The DART Vibe transmitter has a feedback function in the form of vibration, which is a confirmation that the signal from the transmitter was received.



SECTIONAL DOOR



UniPro SNP | RAL 9005 | silkline



UniPro SNP | winchester 49240 XA | smoothgrain



TECHNICAL DATA

	UniPro SNP
Leaf	A panel made of galvanized steel sheet with two-side polyester coating, galvanized and painted on both sides, infilled with high density PU foam $g=42 \text{ kg/m}^3$ without HCFC
Spring type	Pull springs, mounted along the vertical tracks
Minimum number of cycles	20,000
Thermal transmittance factor U of the panel [W/m ² ·K]	0.48
Watertightness class	2 in accordance with PN-EN 13241-1 section 4.4.2
Wind load resistance class	3 in accordance with PN-EN 13241-1 section 4.4.3
Air permeability class	4 in accordance with PN-EN 13241-1 section 4.4.6
Sound reduction index Rw [dB] without a wicket door / with a wicket door	23 in accordance with PN-EN ISO 717-1: 1999
Safety features	Special shape of the panel preventing fingers from getting crushed. Optional accessories: photocells, RC2 anti-burglary kit.
Optional accessories	Electric drive, ventilated panel, glazing with an aluminium panel, VISUAL glazing without glazing bars, portholes, glass panes: No-Scratch, GREY, SATIN, SAN R, ventilation grilles, lock, photocells, transmitter.
Maximum width / height of the door [mm]	5,000 / 3,000
Available panel rib designs	low ribs, high ribs, V ribs, without ribs, caisson ribs
Available panel structures	woodgrain, smoothgrain, sandgrain, silkline
Available colours:	other RAL, special colours, including wood imitating colours, (film coated panels)

CONTROL THE GARAGE DOOR WITH YOUR SMARTPHONE!

The smartCONNECTED technology brings WIŚNIOWSKI automatic sectional garage doors to the next level of product development, tailoring them to the requirements of increasingly demanding customers. On the one hand, it makes it possible to control the devices with a smartphone, and on the other, it gives the users full control and lets them stay in touch with their home from any place in the world.

io-homecontrol® makes it possible to wirelessly connect the METRO Smart io and METRO io drive units to the smart home system controlled by the selected TaHoma Switch central control unit. Building a comprehensive smart home provides a number of benefits and additional features that enhance your comfort every single day.



Let us inspire you!
See other solutions from WIŚNIOWSKI!



WIŚNIOWSKI

WIŚNIOWSKI Sp. z o.o. S.K.A.
PL 33-311 Wielogłowy 153
tel. +48 18 44 77 111
Fax +48 18 44 77 110

www.wisniowski.pl/en

The products shown in this publication often feature special accessories and do not always correspond to their standard versions • The technical data sheet does not constitute an offer within the meaning of the Polish Civil Code • The manufacturer reserves the right to introduce changes without notice • NOTE: The colours shown in the technical data sheet are for reference only • All rights reserved • Copying and use, in part or in full, is prohibited without the consent of WIŚNIOWSKI Sp. z o.o. S.K.A. • UniPro/07.24/EN